

# JFK Miles for Minds 5K Course Map(not to scale)

## Roosevelt Park

Edison, NJ

NJ09022LMB

Effective 7/1/2009 to 12/31/2019

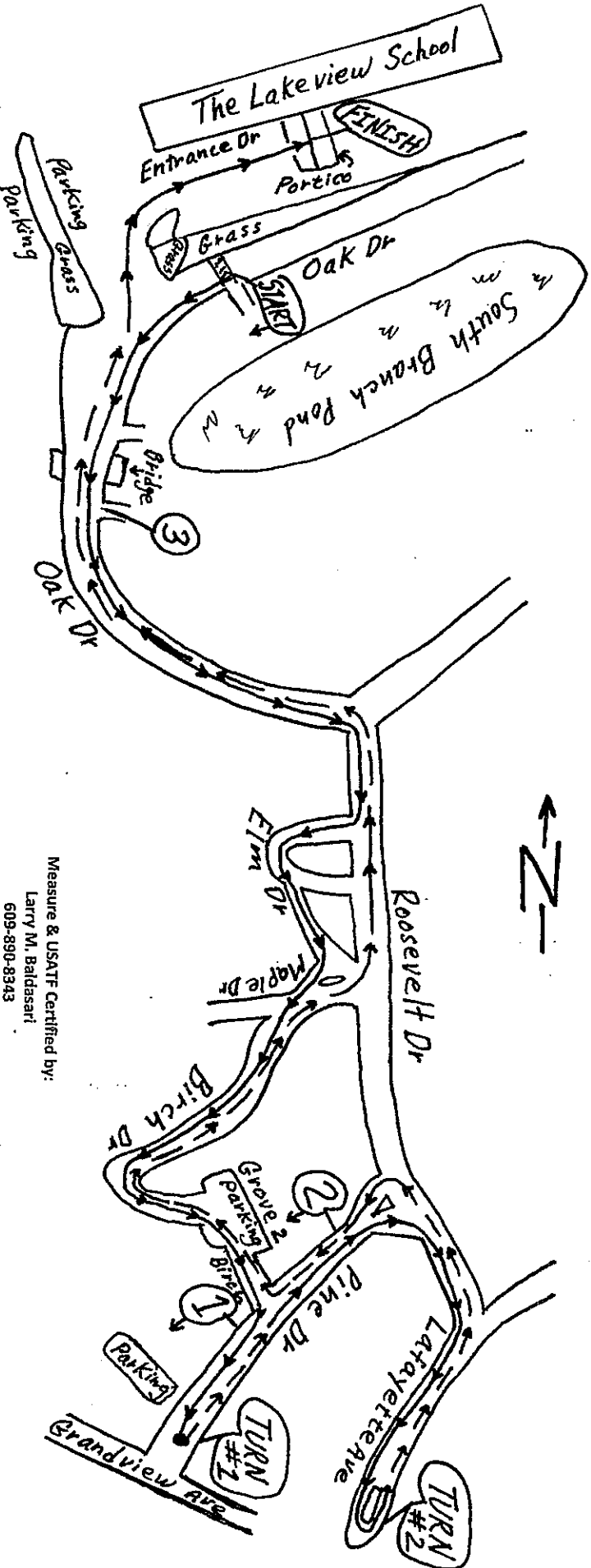

**START**- On Oak Dr, directly at the N. edge of the N. crosswalk line of the crosswalk that is located at the S. end of the Lakewood School and leads to the lake & bike path; 45' N. of the flagpole on the S.W. side School lawn; 33' S. of the S. edges of the sewer grates on the W. & E. sides of road.

**1 MILE**- On Pine Dr, W. bound, just W. of Birch Dr & across from the Theatre's Handicap Parking Lot; 25' W. of the W. end of the Birch Dr's W. corner curb line; 1' W. of the "SPEED LIMIT 30" sign pole on N. side; 45' E. of light pole #13295 on S. side.

**TURNAROUND #1**- On Pine Dr, between the parking lot on N. side & Grandview Ave; 63' W. of the flagpoles for the Middlesex Co. Veterans Memorial, 34' W. of the W. end of the sewer grate on N. side; 25' E. of the "Pedestrian Crossing" sign pole on S. side.

**TURNAROUND #2**- Directly at the S. end of the Lafayette Ave. parking lot island.

**2 MILE**- On Pine Dr, W. bound, between Roosevelt Dr & Birch Dr; across from the E. end of the Theatre complex on S. side & just E. of the playground on N. side; 125' W. of the W. pointed end of the grass triangle that forms the intersection with Roosevelt Dr; 48' E. of the "SPEED LIMIT 30" sign pole on N. side.

**3 MILE**- On Oak Dr, at the S.E. end of the lake bike path; 15' E. of the E. end of the concrete bridge on N. side.

**FINISH**- On the upper entrance driveway for the Lakeview School, under the entrance portico, directly at the S. edge of the Northernmost faded crosswalk line that is directly across from the middle of the Northernmost entrance door; 9' S. of the S. end of N. pillar on the center traffic island; 16' N. of the N. end of the S. pillar.

Measure & USATF Certified by:

Larry M. Baldasari

609-890-8343

larsurf@aol.com

7/1/2009